

USER MANUAL

Central Vacuum System



Intertek

2000868

Conforms to: UL Std. 1017

Certified to:

CAN/CSA Std. C22.2 No. 243-10

THIS MANUAL APPLIES TO:

HUSKY PRO

TABLE OF CONTENTS

- 1. IMPORTANT SAFETY INSTRUCTIONS3
- 2. GENERAL GUIDELINES & REFERENCE.....4
 - GROUNDING REQUIREMENTS.....4
 - ELECTRICAL REQUIREMENTS.....4
 - GENERAL GUIDELINES TO BE OBSERVED AT ALL TIMES
- 3. MODEL5
- 4. INSTALLATION5
 - POWER UNIT.....5
 - MUFFLER6
- 5. FLEXIBLE HOSE WITH ERGONOMIC HANDLE6
- 6. LOW VOLTAGE WIRE CONNECTION6
- 7. SYSTEM OPERATING INSTRUCTIONS6
- 8. SYSTEM MAINTENANCE7
 - FILTRATION SYSTEM.....7
 - THE PERMANENT FILTER; THE DISPOSABLE FILTRATION BAG
 - DUST CANISTER.....7
 - FLEXIBLE HOSE AND PIPING7
 - MOTOR7
 - HOSE HANDLE7
- 9. TROUBLESHOOTING8
 - LED INTERPRETATION GUIDE8
- 10. SERVICE & COMMITMENT9
 - OUR COMMITMENT: SATISFYING YOUR NEEDS
- 11. RECYCLING INSTRUCTIONS9
- TEN (10) YEAR WARRANTY 10



1. IMPORTANT SAFETY INSTRUCTIONS

READ ALL INSTRUCTIONS BEFORE USING THIS CENTRAL VACUUM SYSTEM

When using an electrical appliance, basic precautions should always be followed:

WARNING - TO REDUCE THE RISK OF FIRE, ELECTRIC SHOCK OR INJURY

- The unit must be used with a properly grounded AC 3-wire electrical system.
- The unit is not to be used near flammable vapours. Sparks from the electric motor may ignite such substances.
- The unit's air outlet may become very hot while and after operating. Avoid all skin contact.
- The power cord should be disconnected from the power outlet before any disassembly of this unit takes place. No adapter must be used.
- If the supply cord is damaged, it must be replaced by the manufacturer, its service agent or similarly qualified persons in order to avoid a hazard.
- Service maintenance and repairs should be performed by qualified personnel only.
- This appliance can be used by children aged from 8 years and above and persons with reduced physical, sensory or mental capabilities or lack of experience and knowledge if they have been given supervision or instruction concerning use of the appliance in a safe way and understand the hazards involved.
- Children shall not play with the appliance.
- Cleaning and user maintenance shall not be made by children without supervision.
- As a security measure, unplug the electrical power cord before proceeding with any maintenance.
- The removal of the plug has to be such that an operator can check from any of the points to which he has access that the plug remains removed (for commercial use models).

WARNING - FOR USE

- The disposable filtration bag must only be used for dry vacuuming. Failure to do so will damage the unit and affect its filtering capabilities.
- For substantial vacuuming of liquids, the disposable filtration bag and the permanent filter must be removed as they prevent water shut-off system from working properly.
- For soapy water pick-up, use a non-foaming product, as foam may prevent the water shut-off system from working properly.

SAVE THESE INSTRUCTIONS

2. GENERAL GUIDELINES & REFERENCE

GROUNDING REQUIREMENTS

These appliances must be grounded. If they should malfunction or breakdown, grounding provides a path of least resistance for electric current to reduce the risk of electric shock. These appliances have a power supply cord of at least 5.4 feet (1.65 m) in length and are equipped with a grounding conductor and grounding plug. The plug must always be plugged directly into an electrical outlet that is properly installed and grounded in accordance with all local codes and regulations.

Do not use an extension cord to plug the system.



WARNING

Improper connection of the equipment grounding conductor can result in a risk of electric shock. Check with a qualified electrician or service person if you are in doubt as to whether the outlet is properly grounded. Do not modify the plug of the appliance – if it will not fit the outlet, have a proper outlet installed by a qualified electrician.

The unit has a grounding attachment plug. Make sure that the power unit is connected to an outlet having the same configuration as the plug. No adapter should be used with this power unit. The power unit should be connected to an independent circuit breaker.

ELECTRICAL REQUIREMENTS

The following model is to be used on a nominal circuit of 15 A at 220-240 Volts A.C. and 60 Hz: P20-290-NA-CCA (HUSKY PRO).

Use with a NEMA 6-15R (15 A, 250 V, 2P, 3W) electrical outlet.



NOTE

Other optional suffixes can be used, on all models, to denote cosmetic changes.

GENERAL GUIDELINES TO BE OBSERVED AT ALL TIMES

1. The power unit must be installed in a ventilated area away from any heat source.
2. The Husky PRO central vacuum system may be used on wet and dry surfaces.
3. The filtration cage must be equipped with its permanent filter, except when the unit is used to vacuum liquids.
4. DO NOT vacuum fine dust or any sludgy materials without the paper protection filter pulled over the permanent filter. The paper protection filter prevents caking of fine dust onto the permanent filter which can obstruct the filtration system. This precaution will avoid the overheating of the motor and failure of the power unit to function properly. The paper protection filter is sold separately.
5. The disposable filtration bag and the permanent filter must only be used for dry vacuuming.
6. The motor housing must never be obstructed in any way to avoid overheating of unit.
7. Do not attempt to shorten or modify the unit's electrical power cord.
8. As a security measure, unplug the electrical power cord before proceeding with any maintenance.
9. In order to keep the warranty valid, only a Husky authorized service personnel may carry out the necessary repairs or maintenance on the motor.
10. The warranty will be void if non-recommended products such as filters or any other after-sale parts as carbon brushes and motors are used to repair the unit. Husky recommends strongly to use only Husky certified filters and replacement parts.
11. Appliance must be positioned in a way that the electric plug is always easily accessible.
12. To unplug the hose from the wall, grasp the rigid end cuff and pull it while turning. Never pull on the flexible hose itself.
13. Do not handle the hose or rigid end cuff with wet hands.
14. Never vacuum flammable materials, gaseous or liquid, with your system.
15. Never vacuum ash from your fire place or from your ashtray.
16. The permanent filter must be installed on the unit for every dry vacuuming use.



NOTE

» If the unit is used for dry vacuuming without a permanent filter or if the unit is used to vacuum water with the permanent filter or the paper filter, the warranty will be void!



IMPORTANT

Husky is not responsible for damages resulting from improper use. The warranty does not cover damage resulting from misuse or problems resulting from installation that does not conform to specifications, or any functional alterations and / or physical changes to the power unit. Improper or non-recommended installation of the system and / or power unit done against predefined principles of the user manual is also considered misuse.

All conditions and restrictions are set forth in the Husky limited warranty, the user manual and the system installation guide. To optimize the performance and life of your Husky power unit, it is important to do regular maintenance and cleaning of the permanent filter according to the guidelines listed in this user manual.

3. MODEL

HUSKY PRO (P20-290-NA-CCA)

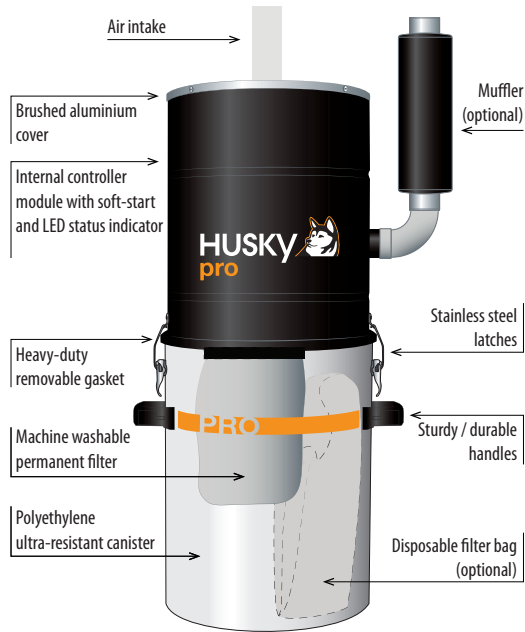

NOTE

» In order to avoid overheating, we recommend 12 in / 30 cm clearance on both sides and in front of the unit.

4. INSTALLATION

POWER UNIT

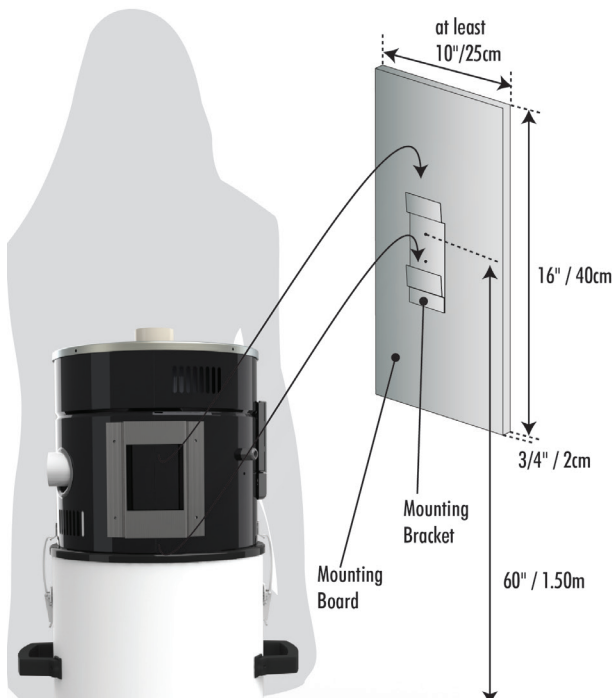

Fig.1 Mounting the unit

The power unit must be installed in a ventilated area, easily accessible and away from any heat source. It should also be close to an accessible electrical outlet.

1. Determine the location of the power unit on the wall; we recommend that the power unit be fastened at 60" / 1,5 m from the ground in order for the dust canister to be readily accessible; allow 12" / 30 cm clearance on all sides of the power unit. When possible, it is advisable to install the power unit on a concrete wall in order to minimize the noise caused by vibrations;
2. Gypsum wall:
 - Prepare the wall by installing a plywood mounting board (not provided) 16" / 40 cm high x 3/4" / 2 cm thick and wide enough to be screwed to at least 2 studs;
 - Fasten the mounting bracket to the mounting board with the provided screws;
3. Concrete wall:
 - Drill the holes with a concrete drill bit;
 - Insert the provided wall anchors into the drilled holes;
 - Fasten the mounting bracket to the mounting board with the provided screws into the anchors;



NOTE

» You can still install a plywood mounting board (16" / 40 cm x 10" / 25 cm x 3/4" / 2 cm) if desired;
 » You can use provided screws to fix mounting board on the wall, but cannot use them for installing the mounting bracket on the mounting board because of their length. You need to use shorter screws (not provided).



IMPORTANT

Always use the right type of screws for the surface you are working with (wood, concrete, metal...)

4. Insert the power unit bracket into the mounting bracket (as shown in figure 1);
5. Insert the PVC pipe into the air intake coupling; **DO NOT GLUE!**
6. Connect the controller module to the low-voltage wire (see section 6);
7. Install the muffler;
8. Connect the power unit directly to an electrical outlet.

MUFFLER

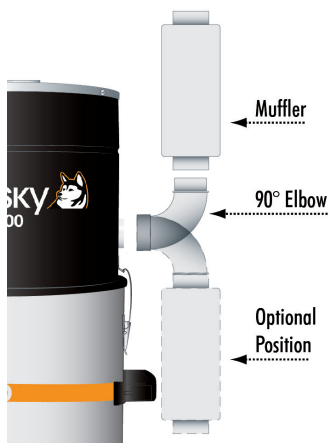

Fig.2 Installing the muffler

The purpose of a muffler is to reduce the sound emitted by the system. To install the muffler on your power unit, follow these simple steps:

1. Turn off and unplug the unit;
2. Attach the 90° long metal elbow upwards or downwards onto the central vacuum outlet (silicone coupler);
3. Secure the muffler onto the 90° long metal elbow using the provided self-tapping screw;

4. **OPTIONAL** - If you plan on exhausting the central vacuum outside, install more metal piping starting from the other end of the muffler.



NOTE

- » The muffler can be oriented in the direction of the exterior vent. The 90° elbow is not mandatory.
- » In case of space restriction around the power unit install the muffler at any convenient distance screwing spare metal piping in place.



IMPORTANT

DO NOT use any plastic piping (e.g. PVC) along the full length of the central vacuum exhaust piping.

5. FLEXIBLE HOSE WITH ERGONOMIC HANDLE



Fig.3 Low voltage technology flexible hose

At Husky, we understand that your cleaning experience with a central vacuum system begins above all with the use of the flexible hose and accessories. This is why we offer products above market standards, on top of having incomparable advantages like the best warranty in the industry.

Your Husky flexible hose comes with a uniquely designed ergonomic handle, which makes its use pleasant and worry free.

In your Husky hose handle, you will find the same quality, durability and solid design made with first-quality materials. The top-of-the-line finish of your Husky flexible hose is perfectly harmonized with a series of accessories chosen by Husky to make a perfect cleaning kit. The performance, simplicity and durability are the three principles which led to the development of your Husky accessory kit. We are convinced that your cleaning experience will be improved by it.

6. LOW VOLTAGE WIRE CONNECTION

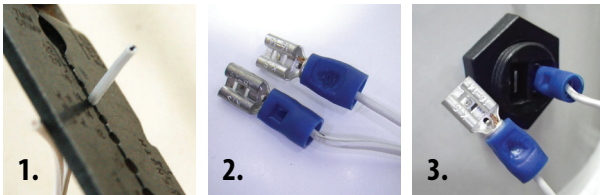

Fig.4 Low voltage wire connection

Before connecting the low-voltage wires, make sure that the power unit is disconnected from the electrical outlet.

1. First, strip the low voltage wires approximately 3/8 in / 10 mm;
2. Crimp the connectors onto the wires in order to hook-up the system.
3. Insert the low-voltage wires into the power unit's low voltage terminal. Slightly pull on the low-voltage wires to verify that they are properly fastened to the terminal.
4. To remove the wires, gently pull the connector out of the socket.

7. SYSTEM OPERATING INSTRUCTIONS

You may vacuum a great variety of materials with your new system, wet or dry. Before each use, you must check that the filtration system in the canister is set up for the type of material you are planning to vacuum.

DRY MATERIALS

The permanent filter must be installed for this type of material. To optimize the filtering capacities of your system, the use of an optional filtration bag is recommended.

FINE DUST, SLUDGY MATERIALS, ETC.

The permanent filter must be installed for this type of material. Pull a paper protection filter (sold separately) over the permanent filter.

LIQUIDS AND DAMP MATERIALS

Take off the permanent filter and all paper filters and bags while vacuuming liquids.

Now your new system is ready to be used, here are some simple guidelines to follow when using your power unit:

- Insert the flexible hose in one of the wall or floor vacuum inlets installed in your home;
- If you use a hose fitted with a switch on the handle, use the interrupter on the hose's handle to turn the power unit on/off.

8. SYSTEM MAINTENANCE

FILTRATION SYSTEM

In order to maintain good air quality in your home, the power unit is equipped with a filtration system. It consists of a permanent filter and an optional disposable filtration bag. The filter separates dust from the air.

THE PERMANENT FILTER

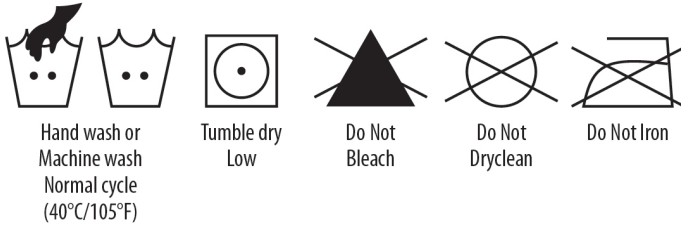

Husky's filtration system will maintain its high performance as long as it is well looked after.

SILPURE is a natural protection (GREEN) against odour-causing bacteria which exploits the natural power of silver in stopping the growth of bacteria. The permanent filter may be machine-washed and tumble dried. It is recommended that the dust canister be emptied every three (3) months or more often depending on the use you make of your system.

The permanent filter should not be used when vacuuming moist or wet materials. It must be removed and cleaned when emptying the canister.



IMPORTANT

DO NOT vacuum gypsum dust, flour, mud, or any sludgy materials with the power unit, except when the paper protection filter is slipped on the permanent filter.

If you are not using a disposable filtration bag in addition to the permanent filter, empty the dust canister regularly to ensure a longer-lasting life of the motor.

If you are using the disposable filtration bag, it should be checked / changed as often as you would empty the dust canister.

While emptying the power unit's dust canister, the permanent filter should also be cleaned:

1. Unlatch the dust canister;
2. Wrap a plastic / paper bag around the filter and gently pat the filter to dislodge any loose dust into the bag.
3. Empty the dust canister into a garbage bag.



NOTE

» We recommend that the permanent filter be deep-cleaned once a year;

a. Remove the dust from the filter by gently patting it into a bag as mentioned above;

b. Remove the filter by pulling it down;

c. Drop it into the washer;

d. Set the washer to a normal wash cycle (warm or cold water), then spin dry (regular cycle) for 10 minutes;

e. Before replacing the filter, clean the inside of the filtration cage.



IMPORTANT

Do not turn filter inside out. It must be replaced over the cage on the same fabric side as initially mounted in the factory.

It is very important that the filter be slipped over the metal rim located at the top of the cage. In order to prevent any dust infiltration into the motor, the cage must be completely covered by the filter;

f. Clip the dust canister back onto the casing.

THE DISPOSABLE FILTRATION BAG

In order to maximize your system's filtration capabilities, every Husky power unit comes with a disposable filtration bag. See below instructions on replacing the disposable filtration bag:

DISPOSABLE FILTRATION BAG	VACUUM MODEL
FILTRE-186	P20-290-NA-CCA

The disposable filtration bag should be changed at least every 3 months to ensure proper functioning of the power unit.

To change the filtration bag, please proceed as follows:

1. Unlatch the dust canister;
2. Remove the disposable bag from the elbow attachment by gently pulling on both sides of the cardboard cuff;
3. Dispose of the full bag;
4. Slip the new disposable filtration bag onto the elbow fixture by gently pressing on both sides of the cardboard cuff until it reaches the stop notch on the elbow.



IMPORTANT

The warranty will be void if non-recommended filters are used to repair the unit. Husky recommends strongly to use only Husky certified filters

DUST CANISTER

Excessive accumulation of dust and dirt in the canister will reduce the system's efficiency. It is advisable to empty the canister frequently. The unit is equipped with a high-level float shutoff system which will block off the vacuum when the fluid level gets to a certain level. The unit should then be shut off and the vacuum canister emptied.

To get maximum efficiency from your vacuum system, it is recommended to clean the canister, the canister gasket and the filtration cage with a damp sponge or cloth after each vacuuming of wet or sludgy materials.



IMPORTANT

Do make sure the canister and the filtration cage are dry and clean before putting back in place the permanent filter and filtration bag.

FLEXIBLE HOSE AND PIPING

After vacuuming wet or heavy and sludgy materials such as mud, it is advisable to thoroughly clean the piping, the flexible hose as well as all accessories used by vacuuming clean water from the same vacuum inlet. Let the unit vacuum air for a few minutes afterwards to empty the piping of all residue and help dry it. This precaution will help prevent clogging and/or bacteria growth in the piping.



IMPORTANT

For security measure, do not forget to take off the permanent filter and the paper protection filter before vacuuming water to clean the piping as they could keep the floater from functioning properly.

MOTOR

All units are equipped with a soft-start control module and have a LED communicating the system status (see fig. 5 in section 9 for more details on LED colour interpretation). When the LED changes to amber, it is time to make an appointment with a Husky certified technician for a complete check-up of the unit. This mandatory maintenance will extend the life of the unit and keep the warranty valid. If it is still not carried out after 20 hours of additional operating, the device will automatically switch off as a safety measure.

All systems also have a mini breaker (power cut-off) directly connected to the module which protects the motor against an overload and prevents overheating.

HOSE HANDLE

Wipe the hose handle regularly with a moist towel to avoid buildup.

9. TROUBLESHOOTING

Failure of the power unit could be caused by:

- Inadequate power level (voltage / amperage) (ensure that power level complies with the power unit's electrical requirements);
- Malfunction of the motor or controller module.

Simple checks can often help you find out why your power unit is not functioning properly. We invite you to verify the following before calling a service technician.

Situation	Verification
NO POWER	Check that the power unit's electrical cord is plugged directly into a power outlet.
	The power unit is equipped with a mini breaker (button on the side of the motor housing) which protects the motor against an overload. To reset the mini breaker, simply push the button. If the unit shuts down again, call a service centre near you.
	Using a screwdriver fitted with a rubber handle, touch both pins of the low voltage terminals (short circuit the 2 pins) on the side of the motor housing. If the power unit starts, the problem lies with the wireless system or the low voltage wiring (installed along the piping).
	You should then verify if the 24 V circuit is adequately connected by checking each vacuum inlet. Open the vacuum inlet cover, touch the small contacts with the head of a pair of metal pliers with rubber handles. This will establish power and start the motor. Repeat for each vacuum inlet.
	NOTE » If all vacuum inlets are functional and your flexible hose is a low-voltage technology handle, there may be a defect in the hose cut-off switch or the hose itself.
DECREASED SUCTION	Check the breaker on your electric circuit panel.
	The flexible hose may be blocked. If you cannot unblock it, try inserting the opposite end of the hose into the wall inlet; touch the contacts which are located on the inside of the inlet with the hose wand in order to start the power unit.
	NOTE » Frame the inlet with your hands or a large enough piece of cloth (such as a towel) to ensure the maximum suction to unblock the hose.
	Check whether the dust canister / disposable filtration bag / permanent filter needs to be emptied / cleaned.
	The power unit is equipped with a stainless steel cage and a float, which will rise and close the motor air intake opening when the canister must be emptied. Check that the float can move freely inside the cage.
	Make sure the canister is clipped properly to the motor housing and the gasket, which fits around it, is in good condition.
	Make sure all inlets are airtight.
	Make sure the piping is glued properly and there is no air leak.
	If the pipes should be blocked behind the walls, it is possible to determine where the blockage is located by starting from the furthest inlet to the central vacuum. Insert a tissue paper and check to see if the tissue paper reaches the dust canister. Repeat the same for each inlet.

LED INTERPRETATION GUIDE

All Husky power units with control module come with an explicative sticker (inside the module casing cover where applicable).

NOTE
» The indicator in step 4 does not apply to this power unit model.

SIGNIFICATION	NIVEAU LEVEL	DEL LED	MEANING
Brancher le cordon d'alimentation à une prise électrique.	0		Plug power cord to electrical outlet.
Le cordon d'alimentation vient d'être branché à une prise électrique.	1		Power cord has just been connected to electrical outlet.
Système opérationnel.	2		System operational.
Vidange/nettoyage requis. Remise à zéro: Garder le bouton enfoncé 5 secondes.	3		Cleaning/emptying required. Reset: hold button pressed for 5 seconds.
Vidange/nettoyage requis. Remise à zéro non requise: l'unité motrice reviendra au niveau 2.	4		Cleaning/emptying required. No reset required: Power unit will return to level 2.
Planifier un appel de service.	5		Schedule service.
Service requis.	6		Service required.

Constante Solid	Clignotement Lent Blinks Slowly	Clignotement Rapide Blinks Fast
------------------------	--	--

Fig.5 LED interpretation guide

10. SERVICE & COMMITMENT

OUR COMMITMENT: SATISFYING YOUR NEEDS

In an effort to always provide customers with the best products available we welcome comments and suggestions from our customers all over the world. We want to develop a strong commitment in providing all of our customers the products which are always of the finest quality that meets or exceeds their needs.

If you have any comments or suggestions related to our products or distributors, please contact us.

For any inquiries:

Call us at:

450-622-9000

1 800-361-3965

E-mail us at:

info@nuera-air.com

Send us your comments to :

Husky – Customer Service

3695 Desserte des Laurentides (A-15) E

Laval, QC H7L 3H7 CANADA

You can also visit us at our web site
to see all our products or find a local
distributor at:

www.huskyvac.com

11. RECYCLING INSTRUCTIONS

Old power units contain valuable materials that can be recycled.

DO NOT dispose of such appliances with the normal domestic waste but rather by way of appropriate collecting points.

TEN (10) YEAR WARRANTY



The team at Husky congratulates you on your purchase and thanks you for the confidence shown towards our high quality products. Husky offers you a ten (10) year warranty on your new power unit, and three (3) years on accessories. The benefits of the warranty are detailed in this document. We invite you to carefully read the information below in order to have a fulfilling and rewarding experience when using your central vacuum system.

TEN (10) YEAR WARRANTY ON POWER UNIT COMPONENTS AND THREE (3) YEAR WARRANTY ON LABOUR

All parts of your Husky power unit are warranted against manufacturing and/or functional defects for ten (10) years, from the original date of purchase at an authorized Husky dealer or store. See "Conditions and details of the ten (10) year warranty" below for normal use conditions covered by this warranty. The warranty is valid for residential use only. Any commercial, cooperative or industrial use voids this warranty. The power unit must be used under normal conditions and with regular maintenance, as indicated in the user manual provided with the system.

CONDITIONS AND DETAILS OF THE TEN (10) YEAR WARRANTY

For ten (10) years from the original date of purchase of the power unit, Husky commits to repair or replace the power unit under warranty. If the power unit cannot be repaired according to the conditions of this warranty, an equivalent replacement power unit will be provided. For the first three (3) years from the original date of purchase of the power unit, Husky commits to repair or replace the power unit under warranty without any labour costs. When the initial three (3) year period has passed, labour costs needed to perform part replacement under this warranty will be charged to the owner of the system. To qualify for this warranty, the owner must immediately contact Husky at **1-800-361-3965** to notify us of any problem with the power unit. Additional instructions shall then be provided. Any travel or administrative costs that may occur will not be reimbursed to the owner of the system by the manufacturer.

A copy of the original receipt must accompany the product for repair. If there is no receipt, the on-line warranty registration done when purchased can be a substitute for the original proof of purchase. The use of electrical currents other than those indicated on the power unit, or any repairs done by non-qualified persons will void this warranty. The warranty will equally be void if the central vacuum system is used to vacuum any material prohibited as mentioned in the user manual. Husky will not be in any way responsible for any damage resulting from use that is not recommended in the user manual. The warranty does not cover damage resulting from abusive use, problems caused by a faulty installation or by any physical and/or functional alterations of the system. Abusive use may be considered if the installation is not done properly or if the guidelines outlined in the user manual or the installation instructions of the system are not followed.

To get maximum benefit of your central vacuum system and to keep the warranty valid, Husky recommends regular cleaning of filters and adhering to the maintenance instructions as described in the user manual. Consumables, such as motor carbon brushes, permanent filters and filtration bags are not covered by this warranty. Any repair, maintenance and replacement of carbon brushes must be done by an authorized technician. Any costs related to normal maintenance including the changing of carbon brushes are the responsibility of the owner.

THREE (3) YEAR WARRANTY ON ACCESSORIES (PARTS AND LABOUR)

All accessories and the hose have a three (3) year warranty on manufacturing defects from the date of the original purchase. The warranty does not cover damage resulting from abusive use or by any physical and/or functional alterations of the accessory or hose. Abusive use may also be considered if the installation is not done properly or if the guidelines outlined in the user manual or the installation instructions of the system are not followed. To qualify from this warranty, the owner must immediately contact Husky at **1-800-361-3965** to notify us of any problem with the defective part. Additional instructions shall then be provided. Any travel or administrative costs that may occur will not be reimbursed to the owner of the system by the manufacturer. The original sales receipt must accompany the defective part.

GENERAL WARRANTY CONDITIONS RELATING TO THE INSTALLATION

Any deviation from the installation instructions from Husky will immediately void any warranty provided by Husky. The installation of the power unit must be done according to the best standards and respecting regulations and other building codes. Husky will not be in any way responsible for any damage resulting from a faulty or improper installation under this warranty. The installer must follow all regulations and laws as well as the installation instructions from Husky in order to maintain this warranty.

ADDITIONAL WARRANTY

Husky is not responsible for any additional warranty sold or otherwise provided to the buyer by an authorized distributor or retailer.

